

Produktinformation

Test indicator MarTest800 SGE



Product features:

- High-contrast dial face, sealed with O-ring
- Mineral glass viewing panel for best protection:
 - against cracking, scratching or damage caused by hot shavings
 - optimum resistance to solvents
- Matt chrome-plated protective casing with three integrated dovetail guide rails
- Shockproof measuring mechanism
- Anti-magnetic model
- Automatic adjustment to the contacting direction ensuring infallible readings
- Ball bearing mounted double lever
- Friction clutch overload protection



Artikel-Nr.: 4308220

Application:

- Measurement of concentricity, alignment, parallelism and flatness
- Centering of bores and shafts
- Parallel or perpendicular alignment of work pieces

Package contains:

- case
- instruction manual
- spanner for changing the styli
- stylus dia. \varnothing 2 mm
- mounting shaft 800a8

Technische Daten

Measuring range from	-0,07 mm
Measuring range up to	0,07 mm
Material Contact surface	carbide
Readings	0,001 mm
Scale diameter	38 mm
Type of dial face	70-0-70
Dial color	yellow
Measuring force	0,2 N
Range per rev.	0,14 mm
Span of error f_e (μm)	3 μm
Total span of error f_{ges} (μm)	4 μm
Hysteresis f_u (μm)	2 μm
Partial measuring range f_t (μm)	2 μm
Repeatability f_w (μm)	1,5 μm

Abmessungen

Notes dimension	* 800 SGM, 801 SGM, 801 SGE, 800 SRM ** 800 SM, 801 SM *** 800 SGE
Stylus length	9,15 mm

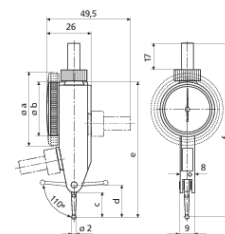

Produktinformation

Test indicator MarTest800 SGE

Zubehör

Bezeichnung	Typ	Artikel-Nr.
Stylus	800 te	4308851
Stylus	800 te	4308850
Stylus	800 te	4308852
Stylus	800 ter	4309050
Spanner		4305868