

Produktinformation

Test indicator MarTest800 SGB



Product features:

- High-contrast dial face, sealed with O-ring
- Mineral glass viewing panel for best protection:
 - against cracking, scratching or damage caused by hot shavings
 - optimum resistance to solvents
- Matt chrome-plated protective casing with three integrated dovetail guide rails
- Shockproof measuring mechanism
- Anti-magnetic model
- Automatic adjustment to the contacting direction ensuring infallible readings
- Ball bearing mounted double lever
- Friction clutch overload protection

Artikel-Nr.: 4301300

Technische Daten

Measuring range from	-0,5 mm
Measuring range up to	0,5 mm
Material Contact surface	carbide
Readings	0,01 mm
Scale diameter	38 mm
Type of dial face	50-0-50
Dial color	yellow
Measuring force	0,07 N
Range per rev.	1 mm
Span of error fe (µm)	10 µm
Total span of error fges (µm)	13 µm
Hysteresis fu (µm)	4 µm
Partial measuring range ft (µm)	5 µm
Repeatability fw (µm)	3 µm

Application:

- Measurement of concentricity, alignment, parallelism and flatness
- Centering of bores and shafts
- Parallel or perpendicular alignment of work pieces

Package contains:

- case
- instruction manual
- spanner for changing the styli
- stylus dia. ø 2 mm
- mounting shaft 800a6 (800 SA/SGA/SGB)
- mounting shaft 800a8

Abmessungen

Notes dimension	* 800 SGL, 801 SGL, 800 SGB ** 800 SL, 801 SL *** 800 SGB
Stylus length	32,299999 mm

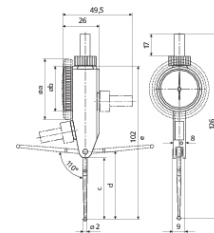

Zubehör

Bezeichnung	Typ	Artikel-Nr.
Stylus	800 tb	4301851
Stylus	800 tb	4301850
Stylus	800 tb	4301852
Stylus	800 tbr	4309052
Spanner		4305868