

# Produktinformation

## Test indicator MarTest800 SG



### Product features:

- High-contrast dial face, sealed with O-ring
- Mineral glass viewing panel for best protection:
  - against cracking, scratching or damage caused by hot shavings
  - optimum resistance to solvents
- Matt chrome-plated protective casing with three integrated dovetail guide rails
- Shockproof measuring mechanism
- Anti-magnetic model
- Automatic adjustment to the contacting direction ensuring infallible readings
- Ball bearing mounted double lever
- Friction clutch overload protection

Artikel-Nr.: 4307200

### Technische Daten

<b>Measuring range from</b>	-0,4 mm
<b>Measuring range up to</b>	0,4 mm
<b>Material Contact surface</b>	carbide
<b>Readings</b>	0,01 mm
<b>Scale diameter</b>	38 mm
<b>Type of dial face</b>	40-0-40
<b>Dial color</b>	yellow
<b>Measuring force</b>	0,15 N
<b>Range per rev.</b>	0,8 mm
<b>Span of error fe (µm)</b>	10 µm
<b>Total span of error fges (µm)</b>	13 µm
<b>Hysteresis fu (µm)</b>	3 µm
<b>Partial measuring range ft (µm)</b>	5 µm
<b>Repeatability fw (µm)</b>	3 µm

### Application:

- Measurement of concentricity, alignment, parallelism and flatness
- Centering of bores and shafts
- Parallel or perpendicular alignment of work pieces

### Package contains:

- case
- instruction manual
- spanner for changing the styli
- stylus dia. ø 2 mm
- mounting shaft 800a8

### Abmessungen

<b>Notes dimension</b>	* 800 SG, 800 SGA, 801 SG, 801 SGE, 801 SGL ** 800 S, 800 SA, 801 S1, 801 S
<b>Stylus length</b>	14,5 mm

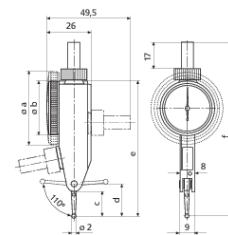

### Zubehör

Bezeichnung	Typ	Artikel-Nr.
Stylus	800 ts	4305870
Stylus	800 ts	4305850
Stylus	800 ts	4305871
Stylus	800 tsr	4309051
Spanner		4305868