

Shell end mills

HR, semicoarse teeth

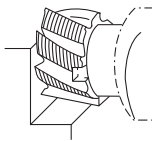

- CZ** Frézy válcové čelní | HR, polohrubozubé
- DE** Walzenstirnfäser | HR, Mittelgrobezahnt
- RU** Фрезы цилиндрические торцевые | HR, среднезубые

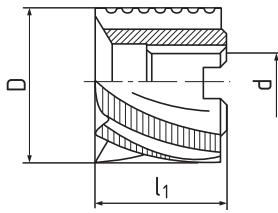

6282



6282



| D js 16 | d H 7 | l1 | Z | 628275 | 628275 |
|------------|----------|----|----|--------|------------|
| 40 | 16 | 32 | 8 | .040 | .040 TIALN |
| 50 | 22 | 36 | 8 | .050 | .050 TIALN |
| 63 | 27 | 40 | 10 | .063 | .063 TIALN |
| 80 | 27 | 45 | 10 | .080 | .080 TIALN |
| 100 | 32 | 50 | 12 | .100 | .100 TIALN |

Cutting conditions | Řežné podmínky | Schnittbedingungen | Условия резания

| Material | A _p | A _e | V _c | f _z (mm/z) | | | | |
|--|--------------------|----------------|----------------|-----------------------|-------|-------|-------|-------|
| | | | | Ø 40 | Ø 50 | Ø 63 | Ø 80 | Ø 100 |
| P.2 ≤ 850 N/mm ² | 0,8x _{l1} | 0,75xD | 32,5 | 0,096 | 0,102 | 0,120 | 0,132 | 0,138 |
| P.3 ≤ 1100 N/mm ² | 0,8x _{l1} | 0,75xD | 18 | 0,096 | 0,102 | 0,120 | 0,132 | 0,138 |
| P.4 ≤ 900 N/mm ² | 0,8x _{l1} | 0,75xD | 25 | 0,096 | 0,102 | 0,120 | 0,132 | 0,138 |
| P.5 ≤ 1100 N/mm ² | 0,8x _{l1} | 0,75xD | 18 | 0,096 | 0,102 | 0,120 | 0,132 | 0,138 |
| M.2 750 - 850 N/mm ² | 0,8x _{l1} | 0,75xD | 10 | 0,096 | 0,102 | 0,120 | 0,132 | 0,138 |
| K.2 > 800 N/mm ² | 0,8x _{l1} | 0,75xD | 22 | 0,096 | 0,102 | 0,120 | 0,132 | 0,138 |
| S.1 ≤ 1500 N/mm ² | 0,8x _{l1} | 0,75xD | 8 | 0,067 | 0,071 | 0,084 | 0,092 | 0,097 |

TiAlN: Vc + 50 %