

STFC(RL) INT

P M K N S H

S

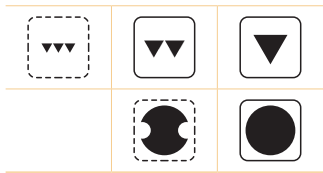
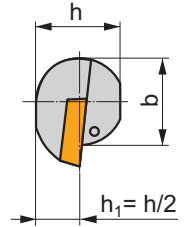
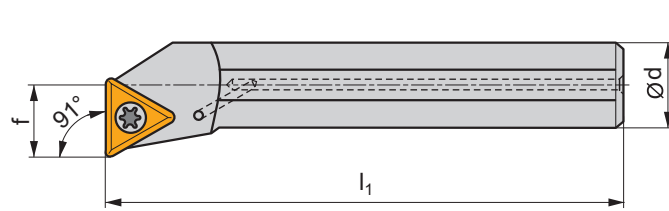
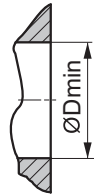
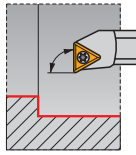

ISO	d	D _{min}	f	h	b	l ₁	λ _s °	γ°		kg		
A06F-STFCR/L 06	6	8,5	4,5	5	-	80	-12	0	✓	0,02	GI217	ST22
A08H-STFCR/L 06	8	11	5,9	7	-	100	-10	0	✓	0,04	GI217	ST23
A10K-STFCR/L 09	10	13	7	9	-	125	-9	0	✓	0,06	GI218	ST24
A12M-STFCR/L 09	12	16	9	11	-	150	-6,5	0	✓	0,11	GI218	ST24
S10H-STFCR/L 11	10	13	7	9	9,5	100	-10	0		0,06	GI056	SO2
A12M-STFCR/L 11	12	16	9	11	11,5	150	-10	0	✓	0,11	GI056	SO1
S12K-STFCR/L 11	12	16	9	11	11,5	125	-7	0		0,11	GI056	SO1
A16R-STFCR/L 11	16	20	11	14,5	15	200	-7	0	✓	0,25	GI056	SO1
S16M-STFCR/L 11	16	20	11	14,5	15	150	-7	0		0,25	GI056	SO1
A20S-STFCR/L 11	20	25	13	18	18,5	250	-7	0	✓	0,45	GI056	SO1
S20Q-STFCR/L 11	20	25	13	18	18,5	180	-7	0		0,45	GI056	SO1
A25R-STFCR/L 16	25	32	17	23	23	200	-3	0	✓	1,15	GI016	SO8
S25T-STFCR/L 16	25	32	17	23	23	300	-3	0		1,15	GI016	SO8
A32S-STFCR/L 16	32	40	22	30	30	250	-10	0	✓	2,10	GI016	ST10
S32U-STFCR/L 16-A	32	40	22	30	30	350	-10	0		2,10	GI016	ST10

GI016	TC.. 16T3..
GI056	TC.. 1102..
GI217	TC.. 06T1..
GI218	TC.. 0902..

SO1	US 2506-T07P	0,9	M2,5	6,5	-	-	FLAG T07P	-	-
SO2	US 2505-T07P	0,9	M2,5	5,4	-	-	FLAG T07P	-	-
SO8	US 3510-T15P	3,0	M3,5	10,6	-	-	FLAG T15P	-	-
ST10	US 3510-T15P	3,0	M3,5	10,6	STN 160308	MS 3510	FLAG T15P	HXK 3,5	-
ST22	5513 020-28	0,6	M2	4,2	-	-	-	-	PT-8000
ST23	5513 020-27	0,6	M2	4,9	-	-	-	-	PT-8000
ST24	5513 020-05	0,8	M2,2	6,4	-	-	-	-	PT-8001